



Spencer.

26, Ladysmith Avenue, Nether Edge, S7 1SF

Buy —

this fantastic four double bedroom, stone fronted traditional end terrace home in one of Sheffield's most sought after postcodes.

— from *Spencer*.

- Superb four double bedroom traditional end terrace
- Cosy front aspect living room with woodburner
- Open plan kitchen diner and family space
- Four double bedrooms and well fitted family bathroom
- Good sized storage cellar
- Rear and side courtyard garden with option for off street parking
- Excellent location and great school catchment
- Council Tax Band - C
- EPC Rating - D
- What3Words///deceased.script.dr



Offers Around

£375,000



Floorplan

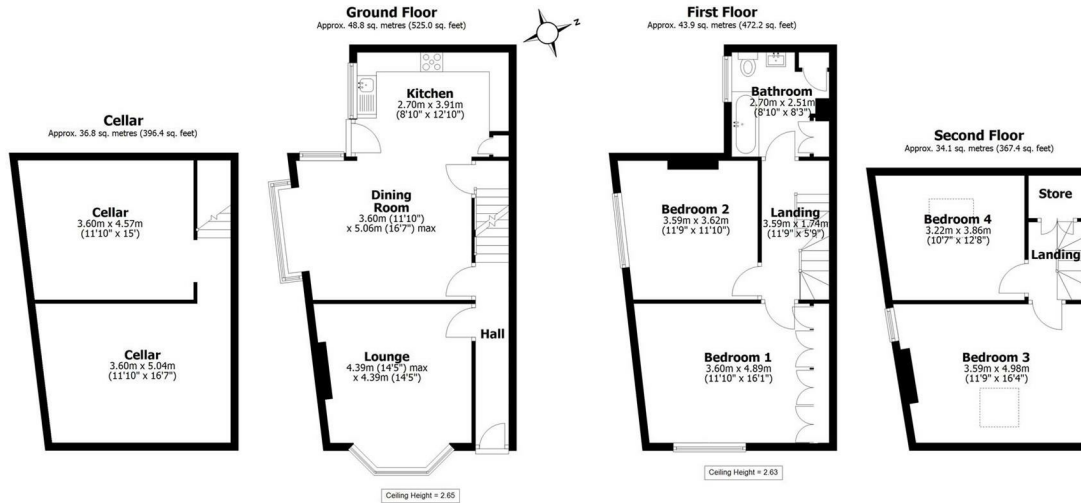

Total area: approx. 163.6 sq. metres (1761.0 sq. feet)

All measurements are approximate
Yorkshire EPC & Floor Plans, Ltd.
Plan produced using Planitup.

26 Ladysmith Avenue

Spencer.

+44 (0)114 268 3682

info@spencersestateagents.co.uk

469 Ecclesall Road, Sheffield, S11 8PP

SpencersEstateAgents.co.uk

Twitter SpencersAgents

Instagram SpencersAgents

Facebook SpencersEstateAgents

All enquiries and negotiations conducted via the Spencers office. We are obliged under the Estate Agent Act 1991 to qualify all offers and an independent mortgage consultant will speak to you to substantiate your details. The particulars are set out as a general outline only for guidance and do not constitute part of an offer or contract. Measurements are given in good faith and believed to be correct. Any prospective buyer should satisfy themselves as to the correctness of all statements and should not rely on them as representation of fact. No person in the employment of Spencers has any authority to make or give representation or warranty whatever in relation to this property.

Viewing: Via the Agents

Spencers Agents Ltd, 469 Ecclesall Road, Sheffield S11 8pp | Registered in England No. 7565948