



Spencer.

Cromwell Street, Walkley, S6

Rent —  
this charming two bedroom mid terraced house, well presented throughout and enjoys a superb sized garden  
— from *Spencer.*

- 
- 2 BEDROOM TERRACE
  - AVAILABLE 24TH FEBRUARY
  - 12 Month Tenancy
  - Holding Deposit £205
  - Security Deposit £1035
  - UNFURNISHED
  - Council Tax Band A
  - EPC Rating D



---

**£900**

PCM



# Floorplan

GROUND FLOOR  
307 sq ft. (28.5 sq.m.) approx.

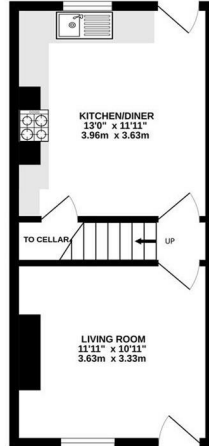

1ST FLOOR  
354 sq ft. (32.9 sq.m.) approx.

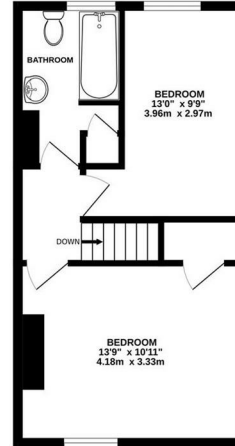

TOTAL FLOOR AREA: 661 sq ft. (61.4 sq.m.) approx.

Whilst every attempt has been made to ensure the accuracy of the floorplan contained herein, measurements of areas, volumes, rooms and any other items are approximate and no responsibility is taken for any error, omission or misstatement. This plan is for illustrative purposes only and should be used as such for any prospective purchaser. The layout, fixtures and appliances shown here are not deemed part of the guarantee, as to their operation or efficiency may vary. Made with Metronix i2022

**Spencer.**

+44 (0)114 268 3682  
info@spencersestateagents.co.uk  
469 Ecclesall Road, Sheffield, S11 8PP  
SpencersEstateAgents.co.uk

**SpencersAgents**  
**SpencersAgents**  
**SpencersEstateAgents**

All enquiries and negotiations conducted via the Spencers office. We are obliged under the Estate Agent Act 1991 to qualify all offers and an independent mortgage consultant will speak to you to substantiate your details. The particulars are set out as a general outline only for guidance and do not constitute part of an offer or contract. Measurements are given in good faith and believed to be correct. Any prospective buyer should satisfy themselves as to the correctness of all statements and should not rely on them as representation of fact. No person in the employment of Spencers has any authority to make or give representation or warranty whatever in relation to this property.

Viewing: Via the Agents  
Spencers Agents Ltd, 469 Ecclesall Road, Sheffield S11 8pp | Registered in England No. 7565948