



Spencer.

1, Stratford Road, Ranmoor, S10 3LR

Buy ———  
an incredible detached house on this incredible road  
in Ranmoor with a huge south facing plot

————— from *Spencer.*

- Large detached four bedroomed house
- Wide south facing plot over half an acre with extensive possibilities
- Far-reaching views towards Ringinglow
- Main bedroom with en-suite bathroom and dressing room
- Four large reception rooms including conservatory
- Breakfasting kitchen with built-in appliances
- No chain and exceptional potential
- Council Tax Rating - G
- What3Words - ///during.feared.doors
- EPC Rating - F possible C



Offers Around

**£1,250,000**







# Floorplan

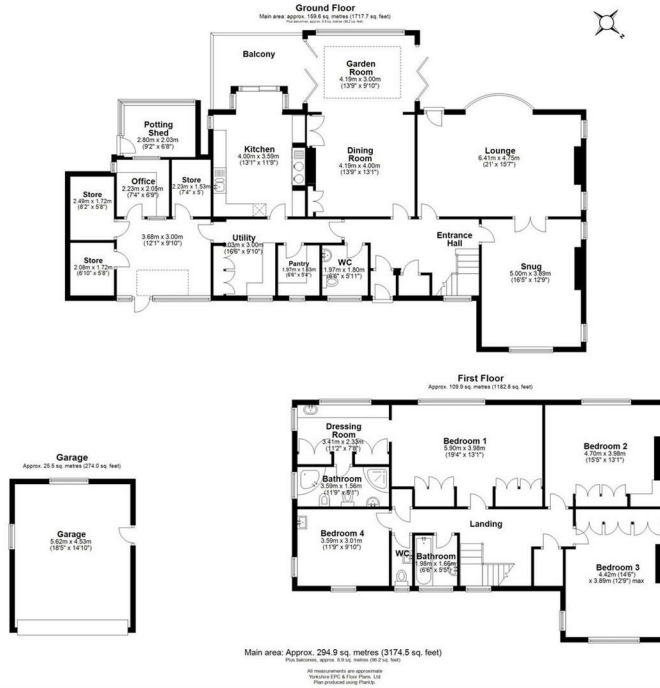

**Spencer.**

+44 (0)114 268 3682  
[info@spencersestateagents.co.uk](mailto:info@spencersestateagents.co.uk)  
 469 Ecclesall Road, Sheffield, S118PP  
[SpencersEstateAgents.co.uk](http://SpencersEstateAgents.co.uk)

**SpencersAgents**  
**SpencersAgents**  
**SpencersEstateAgents**

All enquiries and negotiations conducted via the Spencers office. We are obliged under the Estate Agent Act 1991 to qualify all offers and an independent mortgage consultant will speak to you to substantiate your details. The particulars are set out as a general outline only for guidance and do not constitute part of an offer or contract. Measurements are given in good faith and believed to be correct. Any prospective buyer should satisfy themselves as to the correctness of all statements and should not rely on them as representation of fact. No person in the employment of Spencers has any authority to make or give representation or warranty whatever in relation to this property.

Viewing: Via the Agents  
 Spencers Agents Ltd, 469 Ecclesall Road, Sheffield S11 8PP | Registered in England No. 7565948